

## ■ Profile rail CENTUM XL 100 100 / 100 / 3 mm L= 6 m hot-dip galv.

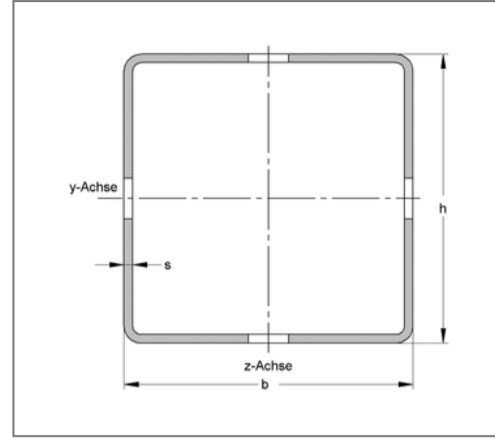
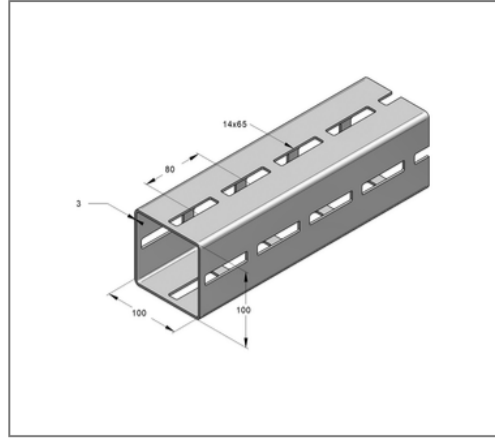
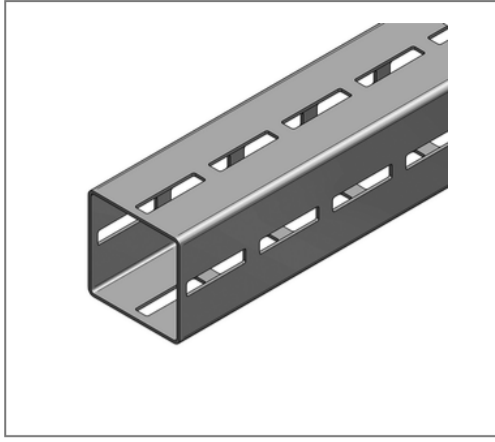

### Commercial details

Part no.	16010060
EAN/GTIN	4250928436634
Packing unit	6 m
Bundle	96 m
Quantity unit	m
Weight	8,46 kg/m
Product group	14-160
Price unit	1

### QR code



### Certification



### Specification

Application area	Heavy-duty profile for modular industrial and plant construction.
Specification	modular system 4-sided without raster in connection with mounting parts torsion stiffness high load capacity

### Technical data

Material	Steel
Material type	S275
Surface	hot-dip galvanized

### Product details

Width	100 mm
Height	100 mm
Thickness	3 mm
Length	6 m
Elongated hole	14x65 mm
Area (least cross section of the profile rail)	9,73 cm <sup>2</sup>
Axial angular impulse $I_y$	157,14 cm <sup>4</sup>
Axial angular impulse $I_z$	157,14 cm <sup>4</sup>
Grid dimension	80 mm
Elastic limit	275 N/mm <sup>2</sup>
Radius of inertia $i_y$	4,02 cm
Radius of inertia $i_z$	4,02 cm
Section modulus $W_y$	31,43 cm <sup>3</sup>
Section modulus $W_z$	31,43 cm <sup>3</sup>